

# EASYWAY® 8E34-1 Assembly Instructions

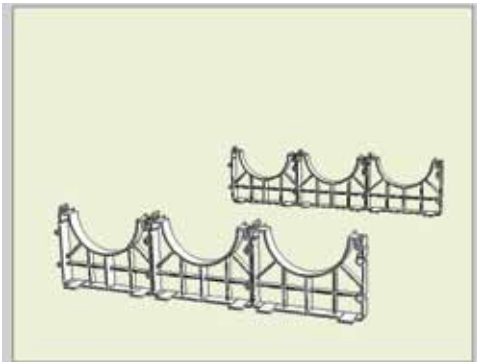

1. Horizontally interlock base spacers and place them in the bottom of trench.

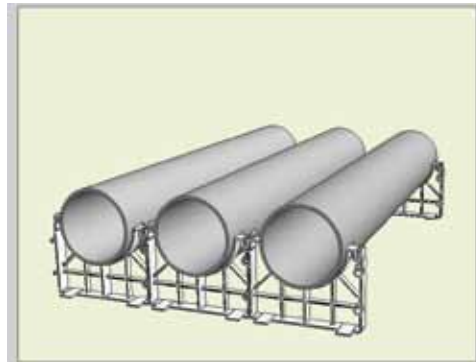

2. Cradle a row of 8" conduits in the base spacers.

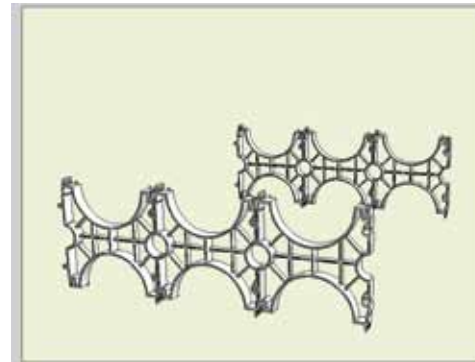

3. Horizontally interlock the next row of intermediate spacers.

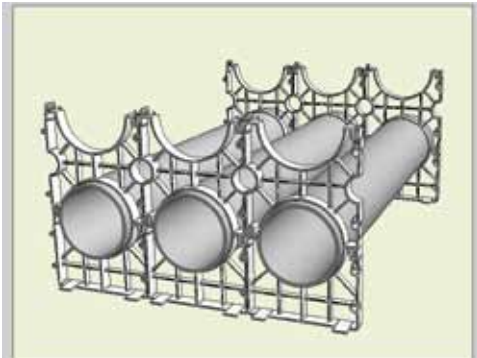

4. Firmly press the intermediate spacer down into the base spacer. (See note 3)

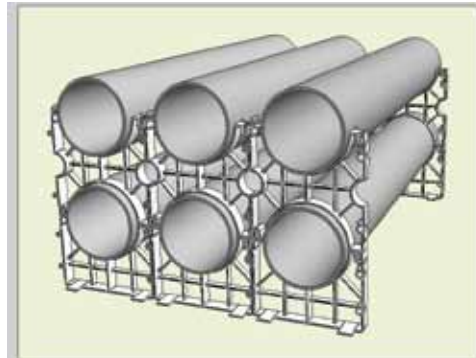

5. Cradle a row of 8" conduits in the intermediate spacer. Repeat steps 3 through 5 for additional rows of conduits.

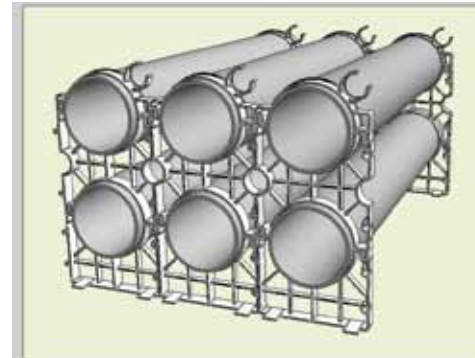

6. Firmly press the top caps down into the intermediate spacers.

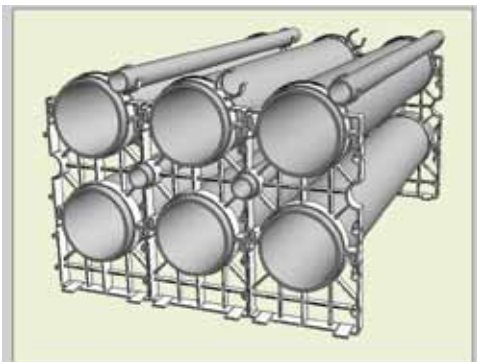

7. Snap 2" conduits into top caps and/or slide 2" conduits into intermediate spacers as required.

### NOTES:

1. Spacers should not be assembled when the temperature of the spacers is below 32° F because the vertical interlocks may crack or break.
2. Once assembled, spacers can not be disassembled.
3. For the slide stops to function properly, they must all be on the same side of the spacer station.

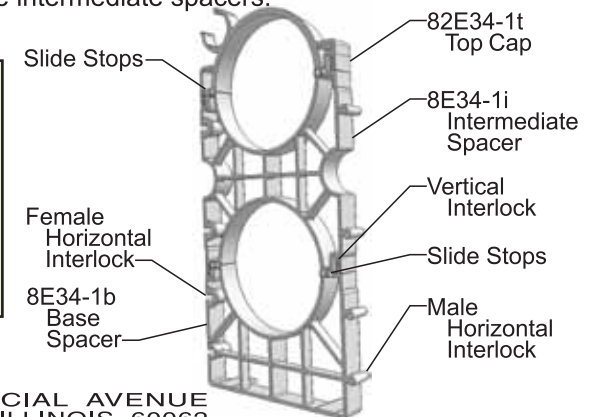

**UNDERGROUND DEVICES**  
INCORPORATED

3304 COMMERCIAL AVENUE  
NORTHBROOK, ILLINOIS 60062  
Phone: (847) 205-9000 • Fax: (847) 205-9004  
Website: <http://www.udevices.com>